

BP-301 SERIES

Back Pressure Regulator // Piston Sensed for Medium Pressure Applications

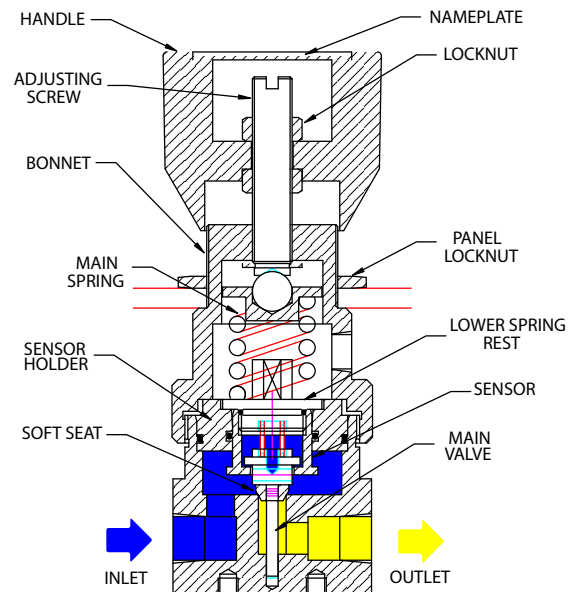

Assembly drawing for reference only. Refer to office for specific detail

The BP-301 incorporates a highly sensitive piston to control pressures up to 70bar with the lower Cv value of 0.1, and 35bar with a higher Cv of 0.5. Both designs provide accurate back pressure control on liquid or gas applications. Unlike relief valves, the set load from the spring is not directly applied to the seating area, and the piston sensor provides accurate control throughout the control range.

APPLICATIONS:

- Fuel Analyzer Systems
- Portable Calibration Kits
- Medium Pressure Reactor Vessels
- Instrument Air Lines

FEATURES:

Lightweight compact design
Piston sensing element
High accuracy

STANDARD MATERIALS OF CONSTRUCTION

Regulator part	Material
Body and Bonnet	316SS
Main valve pin	316SS
Soft seat cone	PEEK – Liquid PCTFE – Gas
Valve spring	Inconel X750
Sensor and holder	316SS
Handwheel	Nylon
Spring rests	316SS
'O' ring seals	Viton
Adjusting screw	Alu Bronze
Loading Spring	302SS

NOTE: Product availability and specifications contained herein are subject to change without notice. Consult local distributor or factory for potential revisions and/or service related issues. // pg 1 of 2

PRESSURE TECH LTD, Unit 6, Graphite Way, Hadfield, Glossop, Derbyshire SK13 1QG
Tel: +44 (0)1457 899307 Fax: +44 (0)1457 899308
e-mail: info@pressure-tech.com

www.pressure-tech.com



Haldatec

Phone: +61-3-9872-5822 Fax: +61-3-9872-5129
E-mail: sales@haldatec.com.au Web Site: www.haldatec.com.au

Designed and built in the UK



BP-301 SERIES

Back Pressure Regulator // Piston Sensed for Medium Pressure Applications

INSTALLATION DIMENSIONS:

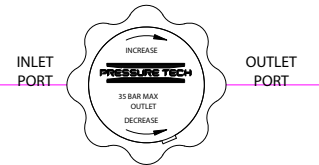
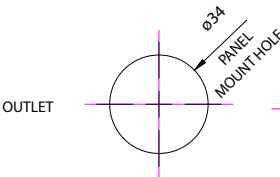
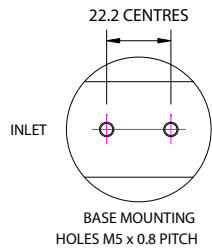
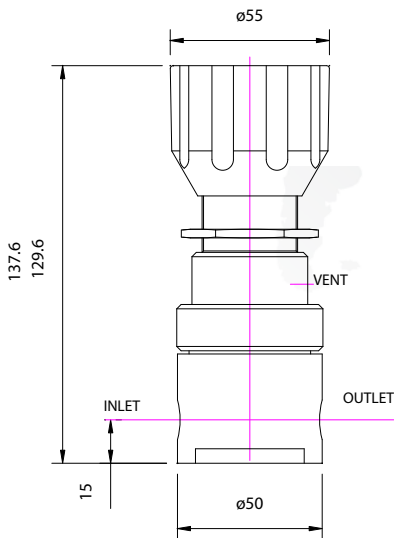

SPECIFICATION :

Max rated inlet pressure225bar (3248psi)
 Inlet ranges..... Flow Cv 0.1: 0.5 – 70bar
 150 – 0 – 150bar Flow Cv 0.5: 0 – 10bar 0 – 20bar, 0 – 35bar
 Design Proof pressure 150% max WP
 LeakageBubble tight at max WP
 Weight 0.9kg (2lbs)

ORDERING INFORMATION:

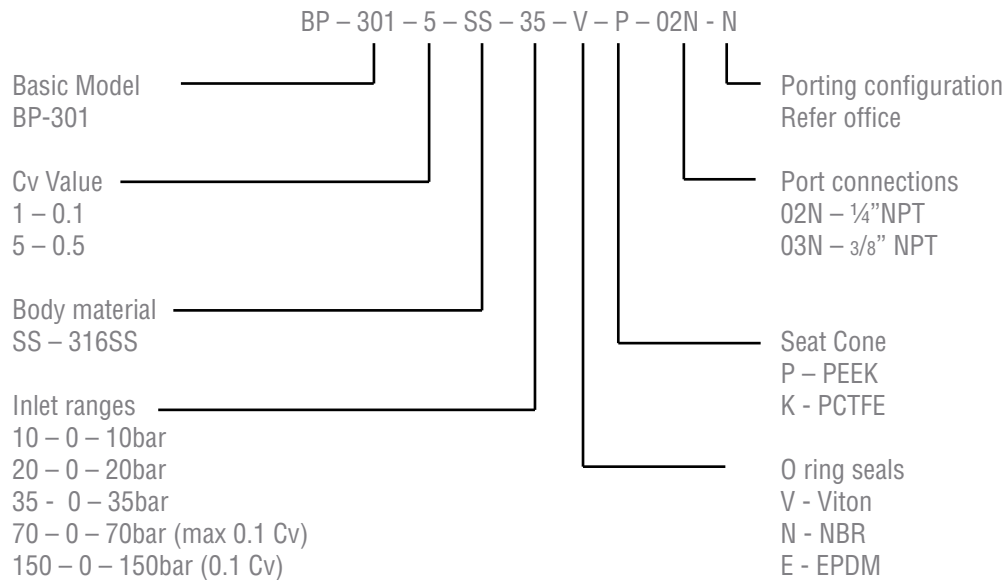

NOTE: Product availability and specifications contained herein are subject to change without notice. Consult local distributor or factory for potential revisions and/or service related issues. // pg 2 of 2